

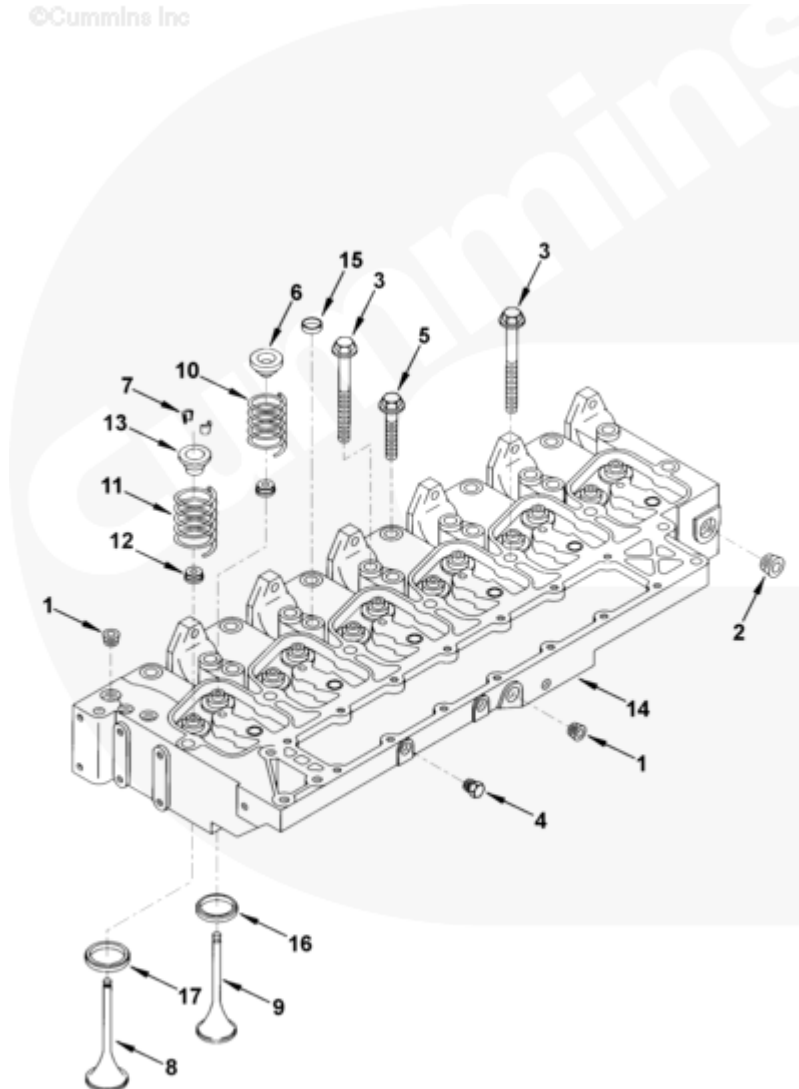

## Parts Catalog - Option Detail

Electronic Parts Catalog - Option Detail				
Option	Group	Graphic	Film Card	Date
PP97024-09	02.01	pp984ge	T	08-DEC-06
<b>Engines</b>	4B3.9, 6A3.4, 6B5.9, B GAS INTERNATIONAL CM556, B4.5, B4.5 CM2350 B129B, B4.5 CM2350 B146C, B4.5 CM2350 B147B, B4.5 RGT, B4.5S, B5.9 G, B5.9 GAS PLUS CM556, B5.9 LPG, B5.9 LPG PLUS CM556, B6.7 CM2350 B121B, B6.7 CM2350 B135B, B6.7 CM2350 B136C, B6.7 CM2350 B148B, B6.7 G CMOH6.0 B125, B6.7N CM2380 B150B, B6.7S, F3.8 CM2350 F120B, F3.8 CM2350 F128C, F3.8 CM2350 F132B, F3.8 F102, G3.9, G5.9, G5.9 CM558, ISB (CHRYSLER), ISB CM2150, ISB CM2150 E, ISB CM550, ISB CM850, ISB/ISD4.5 CM2150 B119, ISB/ISD4.5 CM2150 SN, ISB/ISD6.7 CM2150 B120, ISB/ISD6.7 CM2150 SN, ISB/ISD6.7 CM2880 B126, ISB3.9 CM2220 B107, ISB4.5 CM2150, ISB5.9G CM2180, ISB6.7 2010 DCX PICKUP, ISB6.7 2013 DCX CHASSIS CAB, ISB6.7 CM2150 SQ, ISB6.7 CM2250, ISB6.7 CM2350 B101, ISB6.7 CM2350 B103, ISB6.7 CM2350 B142, ISB6.7 CM2670 B153B, ISB6.7 G CM2180 B118, ISBE CM2150, ISBE CM800, ISBE2/ISBE3 CM850, ISBE4 CM850, ISD4.5 CM2150, ISD6.7 CM2880 D101, ISF2.8 CM2220, ISF2.8 CM2220 AN, ISF2.8 CM2220 EC, ISF2.8 CM2220 ECF2, ISF2.8 CM2220 F101, ISF2.8 CM2220 F117, ISF2.8 CM2220 F122, ISF2.8 CM2220 F126, ISF2.8 CM2220 F129, ISF2.8 CM2220 IAN, ISF3.8 CM2220, ISF3.8 CM2220 AN, ISF3.8 CM2220 F103, ISF3.8 CM2220 F110, ISF3.8 CM2220 F116, ISF3.8 CM2220 F134B, ISF3.8 CM2220 IAN, ISF3.8 CM2350 F109, ISF4.5 CM2220 F123, ISG11 CM2880 G106, ISG11 CM2880 G108, ISG12 CM2880 G107, ISG12 CM2880 G109, ISG12 G CMOH6.0 G111, QSB3.9 30 CM550, QSB3.9 CM2880 B138, QSB4.5 30 CM550, QSB4.5 CM2150 B108, QSB4.5 CM2250 B131, QSB4.5 CM2250 EC, QSB4.5 CM2350 B106, QSB4.5 CM2350 B122			



pp984ge

SMALL | MEDIUM | LARGE

Cart	Ref No	Part Number	Part Description	Required	Remarks
<div style="border: 1px solid black; padding: 2px; display: inline-block;">View My Cart</div>					
		PP97024-09	Cylinder Head		<a href="#">Cylinder Head...(More)</a>
					Engine Family: B Series
					Structure Code: 02 EBM
					Engine Design Phase: Current
					Product
					Cylinder: 6
					Swirl: Low
					MFLD Pressure to Lift EXH
					Valve (PSI): 30

					Notched Head: No
					Cylinder Head Material: Cast
					Iron
					Cylinder Head Valve Material:
					Premium
					Exhaust Manifold Type: Dry
					Exhaust Valve Seal: Improved
					seal
					Valve Seat Inserts: Yes
					Valve Bridge Scalloping: No
					Compression Brake Mounting
					Hardware: No
					Aspiration: Charge Air
					Cooled Sea Water Aftercooled
					Rotators included.
<input type="checkbox"/>	1	3008468	Pipe Plug	6	1/2 NPT.
<input type="checkbox"/>	2	4933532	Pipe Plug	1	3/4 NPT
<input type="checkbox"/>	3	3920780	Hexagon Flange Head Cap Screw	14	
<input type="checkbox"/>	4	3906619	Pipe Plug	2	1/8 NPT.
<input type="checkbox"/>	5	3920779	Hexagon Flange Head Cap Screw	6	
<input type="checkbox"/>		3967448	Cylinder Head	1	Recon Equivalent 3967448 NX
<input type="checkbox"/>	6	3957914	Valve Rotator	6	
<input type="checkbox"/>		3802355	Intake Valve	6	
<input type="checkbox"/>	7	3900250	Valve Collet	2	
<input type="checkbox"/>	8	3920867	Intake Valve	1	Serviced as 3802355
<input type="checkbox"/>		3802481	Exhaust Valve	6	
<input type="checkbox"/>	7	3900250	Valve Collet	2	
	9	3925175	Exhaust Valve	1	Serviced as 3802481
<input type="checkbox"/>	10	3925667	Valve Spring	6	

<input type="checkbox"/>	11	<a href="#">3926700</a>	Valve Spring	6	
<input type="checkbox"/>	12	<a href="#">3957912</a>	Valve Stem Seal	12	
<input type="checkbox"/>	13	<a href="#">3957913</a>	Valve Spring Retainer	6	
<input type="checkbox"/>		<a href="#">3966460</a>	Cylinder Head	1	Komatsu Only
	14	<a href="#">3966459</a>	Cylinder Head	1	
<input type="checkbox"/>	15	<a href="#">3922073</a>	Expansion Plug	5	
<input type="checkbox"/>	16	<a href="#">3925176</a>	Valve Insert	6	
<input type="checkbox"/>	17	<a href="#">3925177</a>	Valve Insert	6	

© 2019 Cummins Inc., Box 3005, Columbus, IN 47202-3005 U.S.A.  
Terms of Use and Disclaimers | Recommended System Requirements  
Need Assistance? Please click on the Contact Us button in the top right corner of any page.